

State of the Department of Medicine

Michael P. Madaio, MD

Sydenstricker Professor and Chairman

September 9, 2014

Department of Medicine
Michael P. Madaio, MD
Sydenstricker Professor and
Chairman

DEPARTMENT
ADMINISTRATOR
Justin Pantano

CARDIOLOGY
Interim Section Chief: Neal Weintraub, MD
Business Operation Specialist: Sherry Brown

DERMATOLOGY
Section Chief: Loretta Davis, MD
Business Manager: Charles Stewart

ENDOCRINOLOGY
Section Chief: Anthony Mulloy, DO
Office Manager: Lynnette Ellison

GASTROENTEROLOGY
Section Chief: Satish Rao, MD
Business Manager: Michelle Hays

GENERAL INTERNAL MEDICINE
Interim Section Chief: Walter J Moore, MD
Business Manager: Donna Renew

HEMATOLOGY & ONCOLOGY
Interim Section Chief: Abdullah Kutlar, MD
Business Manager: Elizabeth Jones

INFECTIOUS DISEASE
Section Chief: Jose Vazquez, MD
Grant Manager: Larry Howell

NEPHROLOGY
Section Chief: Laura Mulloy, DO
Business Manager: Charles Stewart

PULMONARY
Section Chief: William Davis, MD
Business Manager: Michelle Hays

RHEUMATOLOGY
Section Chief: Laura Carbone, MD
Business Manager: Donna Renew

Department of Medicine
OFFICE OF THE CHAIR
Michael P. Madaio, MD
Sydenstricker Professor and Chairman

ADMINISTRATIVE ASSISTANT
Audrey Forbes

VICE CHAIR
CLINICAL AFFAIRS AND FACULTY
DEVELOPMENT
Laura Mulloy, DO

ASSOCIATE VICE CHAIR FOR
TRANSLATIONAL RESEARCH
N Stanley Nahman, Jr, MD

RESIDENCY PROGRAM DIRECTOR
Lee Merchen, MD

CLERKSHIP DIRECTOR OF
INTERNAL MEDICINE
Pam Fall, MD

AMBULATORY MEDICAL DIRECTORS
Alyce Oliver, MD
Namita Mohanty, MD

DEPARTMENT ADMINISTRATOR
Justin Pantano

BUSINESS OPERATIONS
SPECIALIST
Ashley Dutton

ACCOUNTANT 1
Velinda Thomas

Chair's Cabinet



Michael Madaio, MD
Chairman



Laura Mulloy, DO
Vice Chair – Clinical Affairs
& Faculty Development



N. Stanley Nahman, MD
Associate Vice Chair
Translational Research



Lee Merchen, MD
Residency Director



Pam Fall, MD
Clerkship Director



Namita Mohanty, MD
Ambulatory Medical Director



Alyce Oliver, MD
Ambulatory Medical Director



Justin Pantano
Department Administrator

Strategic Priority 1 Education

Provide **exceptional future-oriented learning experiences** for physicians-in-training and other advanced-degree health sciences professionals.

Student Education: Leadership



Pamela Fall, MD
Director, Clerkship



Matt Diamond, DO
Associate Director

Internal Medicine Clerkship Activities



Student Morning Report:

Weekly Teams rotate test questions

Academic Half Day Conferences

- Multi-Campus with MCG Section Chief's.
- Core topics : Cardio, Renal, Hem-Onc, Pul, GI, ID Endo.
- Case Based Discussions



Internal Medicine Clerkship Activities



Chair Rounds

- Case based to facilitate critical thinking in differential diagnosis
- Students review literature relevant to patient
- Recount five things they have learned points
- learned from each session



Clinical Academic Space

- Adding lockers
- Adding computers for student preferential use
- Updating flooring, paint, furniture, and lighting in conference areas
- Downstream effect –
 - Space is being updated for ALL learners
 - Thanks to Dr. Wallach and Dr. Buckley

Paul Wallach, MD
Vice Dean, Academic Affairs



Academic Space - Facilities Upgrade

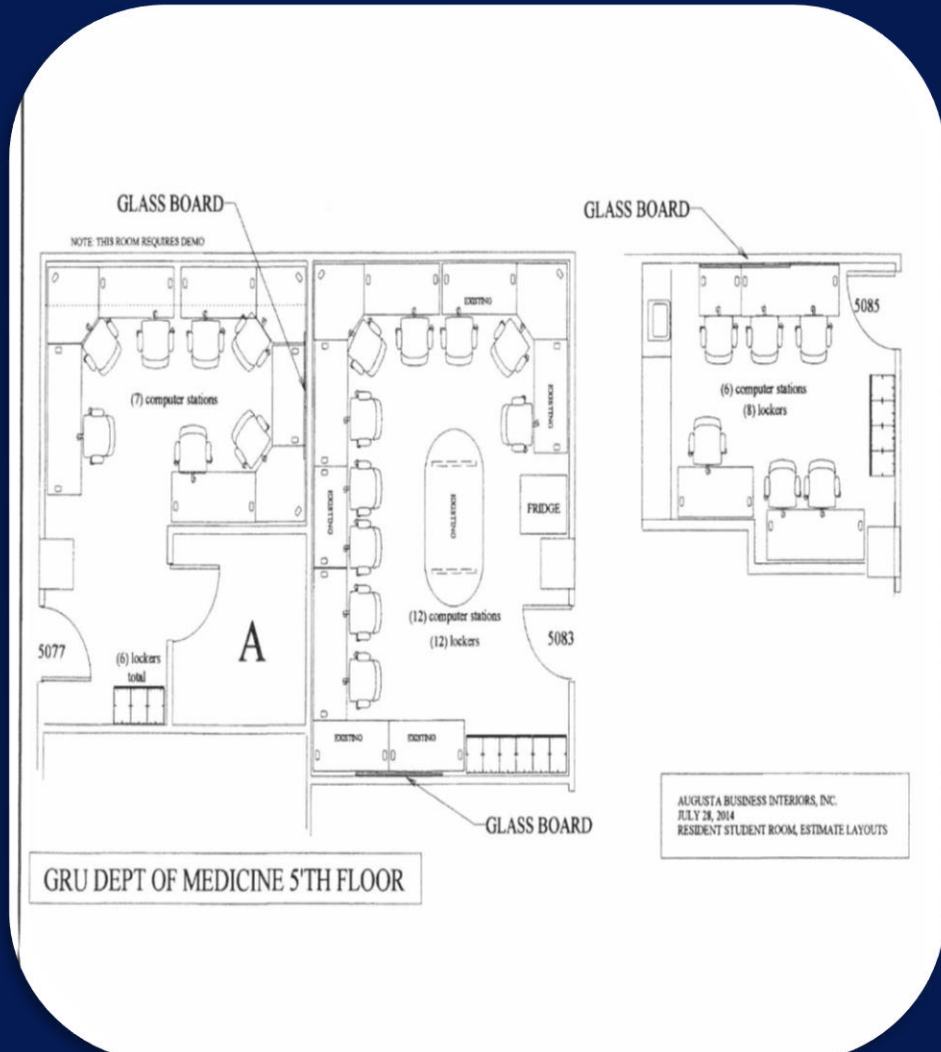
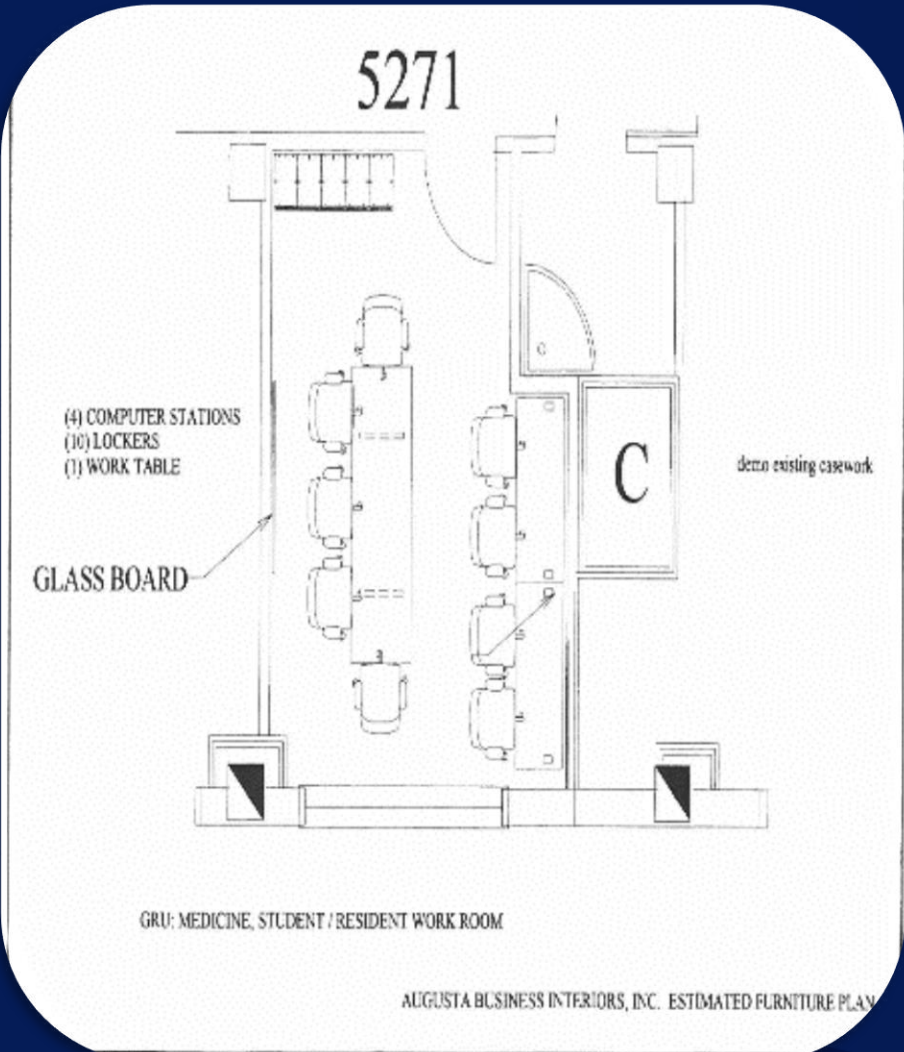

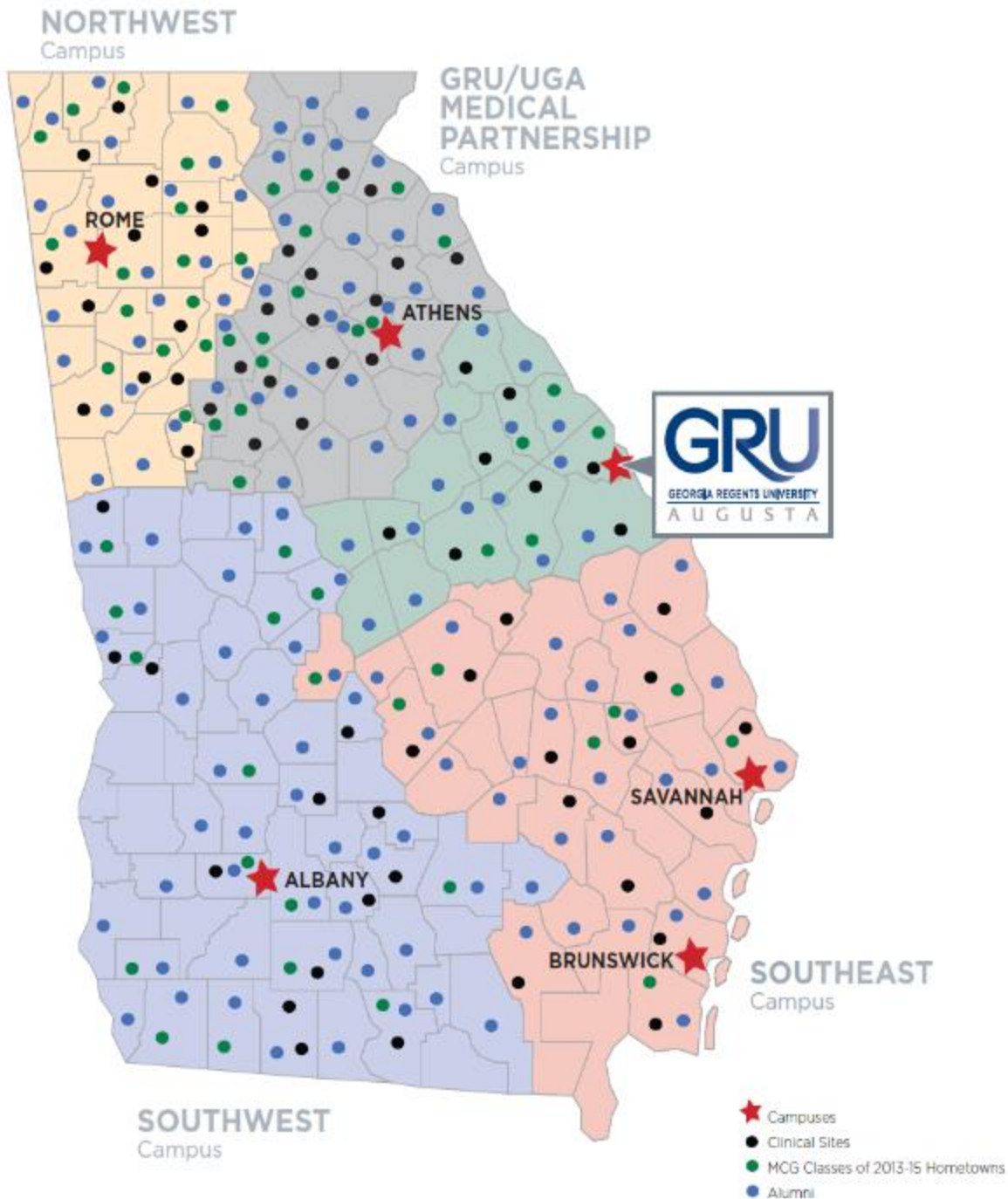

Regional Sites

- Southwest Campus: Albany, GA
- Southeast Campus: Savannah/Brunswick, GA
- Northwest Campus: Rome, GA
- Northeast Campus: UGA/GRU Partnership, Athens, GA

The Medical College of Georgia, the founding school of Georgia Regents University offers clinical training at approximately 135 sites across the state enabling students to experience the full spectrum of medicine from tertiary/quaternary care to small-town solo practices

Northeast Campus (Athens)

- **Four year program**
- **1st Graduating Class 2014**
 - Six members Internal Medicine Residency
 - Emory, John Hopkins, UVA, MUSC, Carolinas and Morehouse.
 - One Med-Peds Louisville
 - **Established Community Health Program**
 - Laurel Murrow, MD - Director

Shining Star Award

- AAMC Group on Regional Medical Campuses

ACGME accreditation - Internal Medicine Program @ St. Mary's Hospital 7/15

- Shelley Nuss, MD Campus Dean for GME @ GRU/UGA Medical Partnership

Ms Tina Duong ('16)

- 1st – student research in Georgia American College of Physicians



Dean: Barbara Schuster, MD

Southwest Campus (Albany)

- All 4th-year students matched
- 20 students for 2014-15; 7 4th year, 13 3rd year
- Eight faculty recruited in Internal Medicine GI, OB/GYN,
- Hosted MCG Leadership tour to showcase quality education on campus
- Faculty development sessions in Albany, Valdosta, and Thomasville
- Phoebe Foundation - donation for construction of med student housing complex.
- Albany hospital - \$1 million donation from Richard King Mellon Foundation
- New SW Campus Psychiatry Clerkship Director, Dr. Joe Morgan
- Certificate of Rural Health is coming to the Southwest campus!

Associate Dean: C. Granville
Simmons, MD, MMM



Southeast Campus (Savannah)

- 20 students - 2016; 17 students - 2015
- 5 - 3rd year Internal Medicine Sites : Savannah, Statesboro, and Brunswick (19 DOM faculty)
- 7 - Amb. Med. Sites - Brunswick, St. Mary's, Savannah, Waycross, Dublin - (15 DOM faculty)
- 2 Critical Care Sites. Savannah, Brunswick , 2 Sub I Sites in Medicine. Brunswick (9 DOM faculty)
- The HOPE certificate program (Health of the Population and Environment)
 - Opportunity for students to learn about population and public health



The Nunnally House
New \$4 M housing for students & families



Steven Chitty MD
Internal Medicine Regional Site Director



Center for Educational Development
\$3M Simulation Center



Assistant Dean:
T. Wayne Rentz, Jr. MD



Associate Dean:
Kathryn Martin, PhD

Northwest Campus (Rome)

- 1st seven students began 2013; Ten new students July 20`4
- Multi-specialty, longitudinal Integrated Curriculum
- Rome community embrace students
- Planned growth with new physicians faculty
- Partners with Redmond Regional
- Medical Center/Harbin Clinic/Floyd Medical Center and Georgia Highlands College



Assistant Dean:
Leonard Reeves, MD, FAAFP

Student Education

MCG Teaching Attendings

David Haburchak, MD	Edward Chin, MD	Andrew Chao, MD
Joyce Gonzales, MD	Subbaramiah Sridhar, MBBS	Caralee Forseen, MD
Lee Merchen, MD	William Salazar, MD	Thaddeus Carson, MD
Laura Carbone, MD	Rene Harper, MD	Cheryl Newman, MD
Walter Moore, MD	Alyce Oliver, MD	Max Stachura, MD
Jaspal Gujral, MD	Anthony Mulloy, DO	Namita Mohanty, MD

2014 Exemplary Teaching Awards Educational Innovation Institute

Student Teaching Awards



Rhonda Colombo, MD
Infectious Disease



Lu Huber, MD
Nephrology



Lee Merchen, MD
General Internal Medicine



Namita Mohanty, MD
General Internal Medicine

Residency Education Leadership



Rene Harper, MD
Associate Director

Thaddeaus Carson, MD
Associate Director

Lee Merchen, MD
Program Director

Shilpa Brown, MD
Associate Director

David Fallaw, MD
Associate Director

2014-2015 Chief Residents



Tom Fortson, MD Andrew Chao, MD

2014 Internal Medicine Residency Program Match

Brian Le Medical College of GA	Shen Chen Medical College of Georgia	Ajay Pillai Medical College of Georgia	Matthew Day Medical College of Georgia
Hammad Aslam Medical College of Georgia	Chaz Fausel Medical College of Georgia	Karl Knights Medical College of Georgia	Xiao Li Medical College of Georgia
Jimmy Ma Medical College of Georgia	Fletcher Moore Medical College of Georgia	Clay Pennington Medical College of Georgia	Greg Schmitz Medical College of Georgia
Anita Rao St. George's University	Wil Navarrete St. George's University	Qusay Haydour University of Damascus	Anas Raed University of Damascus
Zunair Afghani University of North Texas Osteopathic	Yinka Afolabi Indiana University	Zachary Manning University of Missouri	Jason Cuomo Loyola University
Brad Johnson Brody School of Medicine- East Carolina	Ryan Keen American University of the Caribbean	Kiran Joglekar USF Health Morsani	Twinkle Singh Bangalore Medical College
Daniel Hammer Lincoln Memorial University Osteopathic	Rizwan Shaikh American University of Antigua	Rashad Johnson Louisiana State University	Luke Lennard Texas Tech University

Graduating Residents '14

- **Sandeep Arepally** – Pulm/Crit Fellowship GRU f
- **Sara Arney** – Primary Care AVAH
- **Sameer Arora** – Hospitalist - North Carolina
- **Andrew Chao** – Chief Resident GRU
- **Rayhan Chowdhury** – Hospitalist
- **Matt Farmer** – Primary Care - Athens
- **Jason Fombi** –Hospitalist -Northeast Georgia
- **Tom Fortson** –Chief Resident GRU
- **Jim Gilbert** – Hospitalist
- **Ragav Kurl** – Hospitalist - University Hospital
- **Adam McCoy** – Pulm/Crit - GRU for
- **Jitendra Patel** – Hospitalist - North Carolina
- **Pritesh Patel** – Hospitalist - Atlanta
- **Ferdinand Schafer** – Hospitalist -GRU
- **Obi Ukabam** – GI Fellowship University of Texas
- **Jason Velasquez** – Hospitalist Emory

Residency Program Staff



Kathryn Stewart
Office Associate

Donna Renew
Business Manager

Lee Merchen, MD
Program Director

Michelle Torres
Program Coordinator

LaToya Ardis
Office Specialist

Residency Program Highpoints

- **ABIM pass rate up to 93%**
- **Retained MCG students: 24% categorical; 80% preliminary**
- **Drs. Baker, Chalkey and Powner rotate in Peru for international elective**
- **QI Rotation Block Initiated**
- **Resident Satisfaction Up**

Residency and Patient Care



Residency Strategic Planning Committee



Michael Madaio, MD



Lee Merchen, MD



Stan Nahman, MD



Matthew Diamond, DO



Rene Harper, MD



Neil Weintraub, MD



Candice Lovelace, MD



Namita Mohanty, MD



Jose Vazquez, MD



Sherman Chamberlain, MD

**Medical College of Georgia
Residency Strategic Program Plan
Six Strategic Priorities (IN PROGRESS)**

Strategic Priority 1: Ensure Leadership and faculty are aligned with and able to deliver on the comprehensive mission

Strategic Priority 2: Maximize clinical and scientific learning opportunities while delivering excellent patient care

Strategic Priority 3: Improve Resident satisfaction

Strategic Priority 4: Attract highly qualified residents for both clinical and research tracks

Strategic Priority 5: Effectively position and market the department to key audiences (residents)

Strategic Priority 6: Improve resident performance versus benchmarks

Revised Internal Medicine Curriculum

- ✓ Creates accurate and clear expectations for each resident on each rotation.
- ✓ Reflects graduated expectations and includes milestones for next accreditation system.
- ✓ Collaborative effort: input from sub-specialties and residents.
- ✓ Comprehensive, tailored to our training program

Department of Medicine

Internal Medicine Residency Program Curriculum

Program Director: Lee Merchen, MD



Medical College
of Georgia

ACADEMIC YEAR 2014-2015

Mission: To provide the highest quality of education and training for physicians in the field of Internal Medicine through the emphasis of the Core Competencies as described by the Accreditation Council for Graduate Medical Education (ACGME): Patient Care, Medical Knowledge, Professionalism, Systems-Based Practice, Practice-Based Learning and Improvement, and Interpersonal and Communication skills.

Implementation of 4+2 Curriculum

- 4 weeks inpatient medicine followed by 2 weeks outpatient medicine
- Will start 2015-16 Academic Year – JULY 1 2015
- Increase resident exposure to outpatient medicine (+2)
- Outpatient practice training time protected, and no longer competes with ward commitments
- Resident immersion in outpatient care
- Core curriculum in outpatient medicine with involvement of subspecialties

2014 Exemplary Teaching Awards

Educational Innovation Institute

Residency Teaching



Matthew Diamond, DO
Nephrology



Stan Nahman, MD
Nephrology



John Fisher, MD
Infectious Disease



Rene Harper, MD
Endocrinology



Rhonda Colombo, MD
Infectious Disease



Cheryl Newman, MD
Infectious Disease

2014 Exemplary Teaching Awards

Educational Innovation Institute

Residency Teaching



Shilpa Brown, MD
General Internal Medicine



Jaspal Gujral, MD
General Internal Medicine



Namita Mohanty, MD
General Internal Medicine

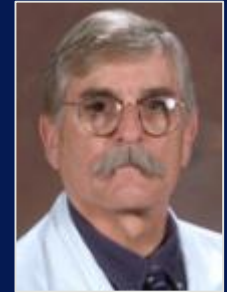

Dean Harrell, MD
General Internal Medicine



Edward Chin, MD
Endocrinology



John Thornton, MD
Cardiology



William Salazar, MD
General Internal Medicine

Fellowship Program Directors



Vincent Robison, MD
Cardiology



Anthony Mulloy, DO
Endocrinology



Satish Rao, MD
Gastroenterology



Huda Salman, MD
Hem/Onc



Rhonda Colombo, MD
Infectious Disease



Jason White, MD
Nephrology



Thomas Dillard, MD
Pulmonary



Alyce Oliver, MD
Rheumatology

“New” Fellows - 2014

Cardiology Fellows

Ismail Tabash – University of Arizona, Tucson, AZ
Lavinia Mitulescu – Norwalk Hospital, Norwalk, CT
Ruchit Shah – Yale Traditional, New Haven, CT
Supawat Ratanapo – Bassett Medical Center,
Cooperstown, NY

Endocrinology Fellow

Gayarti Kuraganti – St. Vincent Hospital,
Worcester, MA

Gastroenterology Fellows

Muhammed Sherid – St. Francis Hospital,
Evanston, IL
Andrew Lake – Wake Forest, Winston Salem, NC

Infectious Disease Fellow

Casey Cronan – Broward Health Medical Center

Hematology/Oncology Fellows

Houssein Talal Abdul Sater – Staten Island, NY
Ibrahim Sadek - University of Michigan
Priyanka Raval – St. Mary’s, St. Louis, MO

Nephrology Fellows

Divakar Jammalamadaka – St. Mary’s Hospital, CT
Jusmin Patel – University of South Alabama
Nardos Belayneh – Kingsbrook Jewish, Brooklyn, NY

Pulmonary Fellows

Sandeep Arepally – MCG, Internal Medicine
Adam McCoy – MCG, Internal Medicine

Rheumatology Fellow

Sunita Paudyal – Grands Rapid Med. Ed., Portland, OR

GOALS: Education

- Finalize and implement Strategic Plan for IM residency
- Recruit 2-4 MCG students/year to categorical residency/year
- Implement outpatient clinical curriculum for 4th year students on GIM and subspecialties
- Offer greater opportunities for career development for residents
- Continue Peru elective
- Implement 4+2 (inpatient + outpatient) block training for categorical residents July 2015 with enhanced outpatient educational opportunities
- Enhance research experience opportunities for fellows

Strategic Priority #2

Research

Generate **outstanding** transdisciplinary, translational, basic, clinical, population, and community-based **research**

Translational Research Program History



N Stanley Nahman Jr, MD
Vice Chairman,
Translational Research
Professor, Nephrology

- Nov. 2012 – Translational Research Program created
Patterned after the CTSA program at Vanderbilt
- Feb. 2013 – Dr. Nahman meets with the leaders of the
Vanderbilt program – ideas from this meeting form the
basis of the TRP vision and mission statement
- Nov. 2013 – Departmental support for research activities
through coordinators, statistical services and other costs
as approved by the working group
- December 2013 – Translational Research Program
becomes active

Translational Research Working Group

N Stanley Nahman, Jr MD	Professor/Vice Chairman	Nephrology
Michael Brands, PhD	Professor	Physiology
Rhonda Colombo, MD	Assistant Professor	ID (Fellowship PD)
Matthew Diamond, DO	Associate Professor	Nephrology
Varghese George, PhD	Professor	Biostatistics (Chair)
Lee Merchen, MD	Assistant Professor	Medicine, Residency Program Director
Francis Yang	Assistant Professor	Biostatistics
Mark Smith, MD, Community Member	N/A	Augusta Nephrology
Kathy Miles	N/A	Director, RDS
Joan Holloway	N/A	Research & Development
Brandi McCorkle	Administrative Assistant	Nephrology

Core working group meets monthly to develop a straightforward set of priorities, policies and oversight to help carry interested investigators forward

Translational Research Program (TRP)

[Home](#) [About Us](#) [Programs](#) [Research](#) [Education](#) [Contact Us](#)



QUICK LINKS Go

[Home](#) » [Colleges](#) » [Medical College of Georgia](#) » [Department of Medicine](#) » [Translational Research Program \(TRP\)](#) » [Translational Research Program \(TRP\)](#)



TRP **Mission**

The mission of the Translational Research Program (TRP) is to foster interest in translational medicine among faculty, fellows, residents and medical students within the Department of Medicine.



TRP **Vision**

The vision of the program is to assist in the conduction of successful translational research projects for individuals at all academic levels, with the ultimate goal being to develop a sustainable TRP that engages the next generation of translational scientists.



TRP **Goal**

The overarching goal of the TRP is to assist in the development of a core group of translational scientists resulting in an improvement in health care, the production of scholarly work (publications), and the generation of extramural funding. To attain this vision, the TRP will act as a resource for interested investigators including students, postgraduate trainees (MD and PhD), attending physicians, basic scientists, statisticians, and others.

Visiting Professors 2014

Sponsored by the TRP



Sam ho, PhD
Gift of Life Michigan
University of Michigan
May 2014

No
Photo
Available

Youli Wang, PhD
Mayo Clinic Rochester
July 2014



Jim Oates, MD
MUSC, SSCI Visiting Professor
Date TBA

TRP Deans Summer Research Program for Med I Students

- 15 students conducted research with DOM faculty mentors
- TRP sponsors - opening mixer (attended by 40)
- TRP with Department of Biostatistics, sponsors weekly summer statistics course for students and trainees
- Students present work at Dean's poster presentation
- Survey provides positive response for program, suggestions for improvement going forward

Dean's Summer Research Program

Student Name	Mentor Name	Title of Project
Sally Osteen	Abdullah Kutlar, MD	The Effect of ACE inhibitors and ARBs on Sickle Nephropathy
Wytch Rigger	Vincent Robinson, MD	Affect of Alpha-Lipoic Acid on Cognitive function and blood vessel health in the elderly
Ankita Tirath	Stanley Nahman, MD	Risk factors for C diff colitis in dialysis patients
Jason Bowman	Thomas Dillard, MD	An analysis of the influence of county wide smoking rates and average indoor radon levels on lung cancer incidence in the Southeast United States
Kyle Bliton	Rita Jerath, MBChB	Pediatric Vasculitis, Looking at Primary Inflammatory Disease of the Brain, Experience at CHOG
Pat Simmons	Rhonda Colombo, MD	Catheter-independent risk factors for Bacteremia in Hemodialysis patients
Erica Eaddy	Abdullah Kutlar, MD	The Role of Endothelin – 1 in Sickle Cell Disease
James Petit	Lu Huber, MD	Risk factors in mortality in patients returning to dialysis
Eric Williams	Stephanie Baer, MD	Demographic disparities and mortality in HIV infected dialysis patients

TRP Work Flow – Faculty Research

Six studios completed

- One voucher authorized
- Two outside departmental collaborations initiated
- Organized research conferences
- Currently 10 active projects under the auspices of the TRP



Project	PI
Crews maneuver	Crews
LD Kidney bx study	Nahman/Dong
Statins and skin	Davis
GI Cancer	Gangreddy
GI—Iron/Vit C	Abdulla
Lupus in ESRD	Machua
Lupus treatment	McGaha
Acthar in dialysis	Nahman
USRDS study groups	Nahman
Virus and the kidney	Colombo
Porcine renal transplants	Merchen, T

Translational Research Program 2014 Highlights/Accomplishments

1st Annual
Resident Research
Competition/Richmond
County Medical Society

Research
Conferences
beginning
9/2014

Vouchers made
available for research
support

Mission:
“To foster interest in
translational medicine
by faculty, fellows,
residents, and medical
students”

Dean's Summer
Research Program

Guidance through
Studio Services offered to
Departmental/Non-
Departmental investigators

Assistance
with Research
Mentors

Website created to assist
with on-line information
and application for
services

GOALS: Research

- Promote the TRP as a means for faculty, trainee and student education
- Promote Interdisciplinary research and through partnerships with funded investigators on campus
- Take advantage of the VA as a means to carry out investigator initiated translational research.
- Engage the senior faculty leadership as promoters of research
- Translate abstracts and presentations into publications and extramural support.

Strategic Priority #3

Clinical

Develop an efficient health care system of quality and value with enhanced access to complex care



Department of Medicine: FY 14 Budget Summary

	<u>FY 14 Budget</u>	<u>FY 2014 Actual</u>
Type A Charges	\$16,146,770	\$19,526,620
Income - Type A - Patient Income	\$6,389,742	\$6,989,726
Total Type B Income (Contracts)	\$351,942	\$343,786
Income - Type C (UPL)	\$317,886	\$328,793
Income - Type M - Med Admin Svc	\$1,005,106	\$1,107,683
Total Clinical Income	\$8,064,677	\$8,769,989
General Expenses of the Group	(\$1,394,972)	(\$1,752,241)
Adjusted Clinical Income	\$6,669,705	\$7,017,748
Department Expenses - General	(\$6,968,655)	(\$7,609,872)
Surplus/(Deficit)	(\$298,950)	(\$592,124)
Investment Income		\$489,775
Ending Balance		(\$102,349)

Medicine Faculty FTE FY14 & FY15

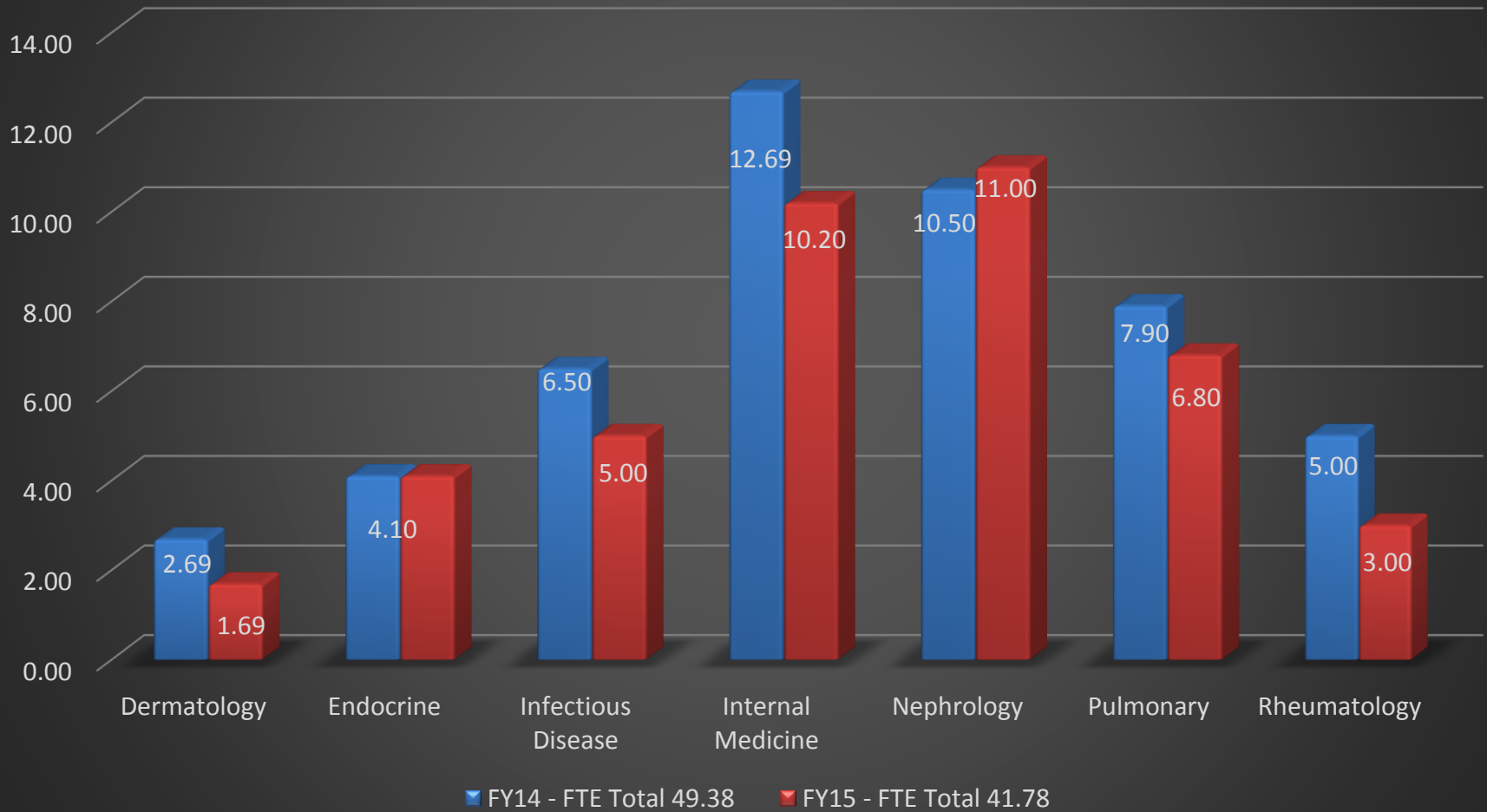

Department of Medicine RVU Summary

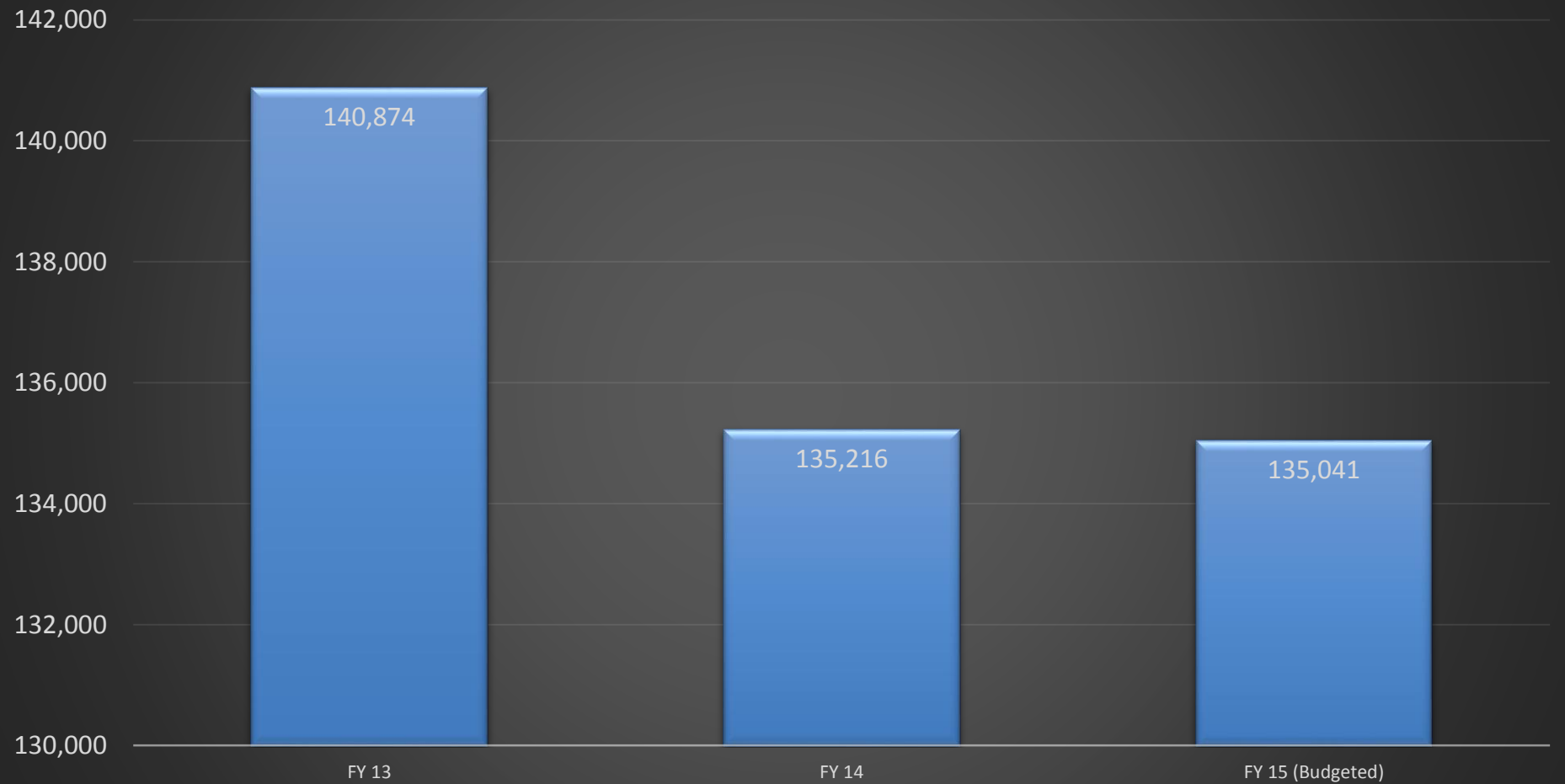

Medicine Practice Volume Trends

GROWTH IN AMBULATORY VISITS

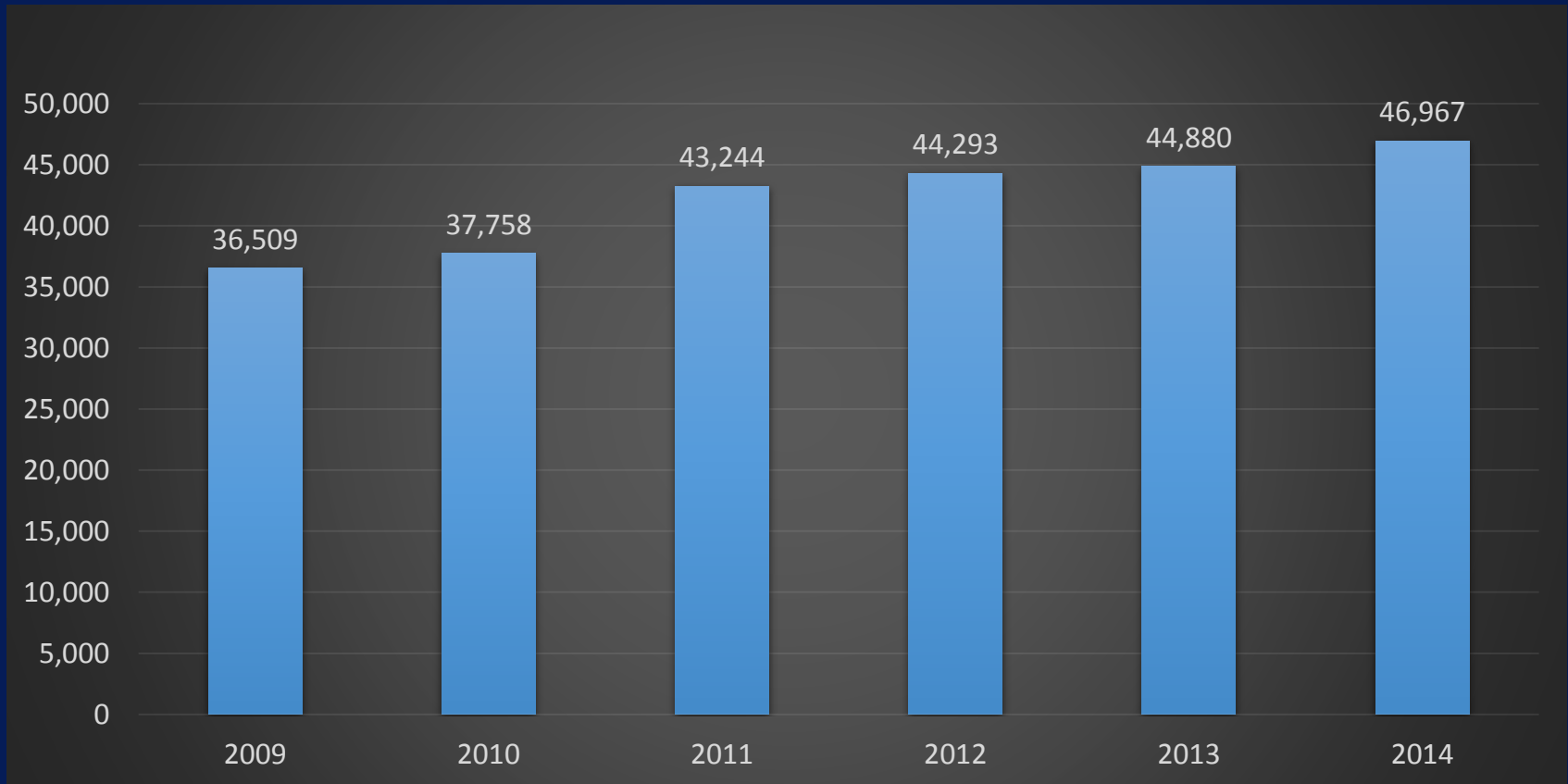

(excluding Card, Gastro & Hem/Onc)

Clinical Practice Strengths

Cardiology	Service Line Growth
Dermatology	MOHS, Clinical Practice
Endocrinology	Thyroid/ Para-Thyroid
Gastroenterology	DHC & Service Line Development
Hematology/Oncology	Sickle Cell & Cancer Center Service Line
Infectious Disease	Anti Microbial Stewardship, ASMP (HIV), BMT Coverage, Research: NIH & Pharma
Internal Medicine	EMR Leadership, Leadership Transition
Nephrology	Transplant Growth, ESRD Growth
Pulmonary	Sleep, ICU Coverage, Cystic Fibrosis, Pulmonary Hypertension, Hereditary Hemorrhagic Telangiectasia
Rheumatology	Osteoporosis, Prison Clinic and West Wheeler Pkwy

New Practice Operations/Programs '13-'14

(examples)

- Motility Practice (GI Service Line - International)
- Weight Loss Surgery Program (GI Service Line)
- Executive Wellness Program (Dr A. Mulloy & Dr. L. Mulloy)
- Mobile Echo (CV Service Line)
- Travel Practice (ID vaccinations, pre-med, physical exams)
- Trinity Hospital (Cardiology, GI, wound care)
- Sleep (Pulmonary- increased capacity on MCG campus)
- Transplant (Dr. Zayas, outreach, program development)

Digestive Health Center



Coming in 2014

Future home of Georgia Regents Digestive Health Center
Learn more at gru.edu/digestivehealth.

GRHealth
GEORGIA REGENTS
DIGESTIVE HEALTH CENTER

Dr. Satish Rao Director, **Multi-Specialty Practice**

5,000 sq. ft state-of-the-art facility

9 procedure rooms; 24 pre/post op rooms 15 exam rooms

Motility center

Weight loss surgery

GRU
GEORGIA REGENTS UNIVERSITY
AUGUSTA

Medical College
of Georgia

Digestive Health Floor Plan

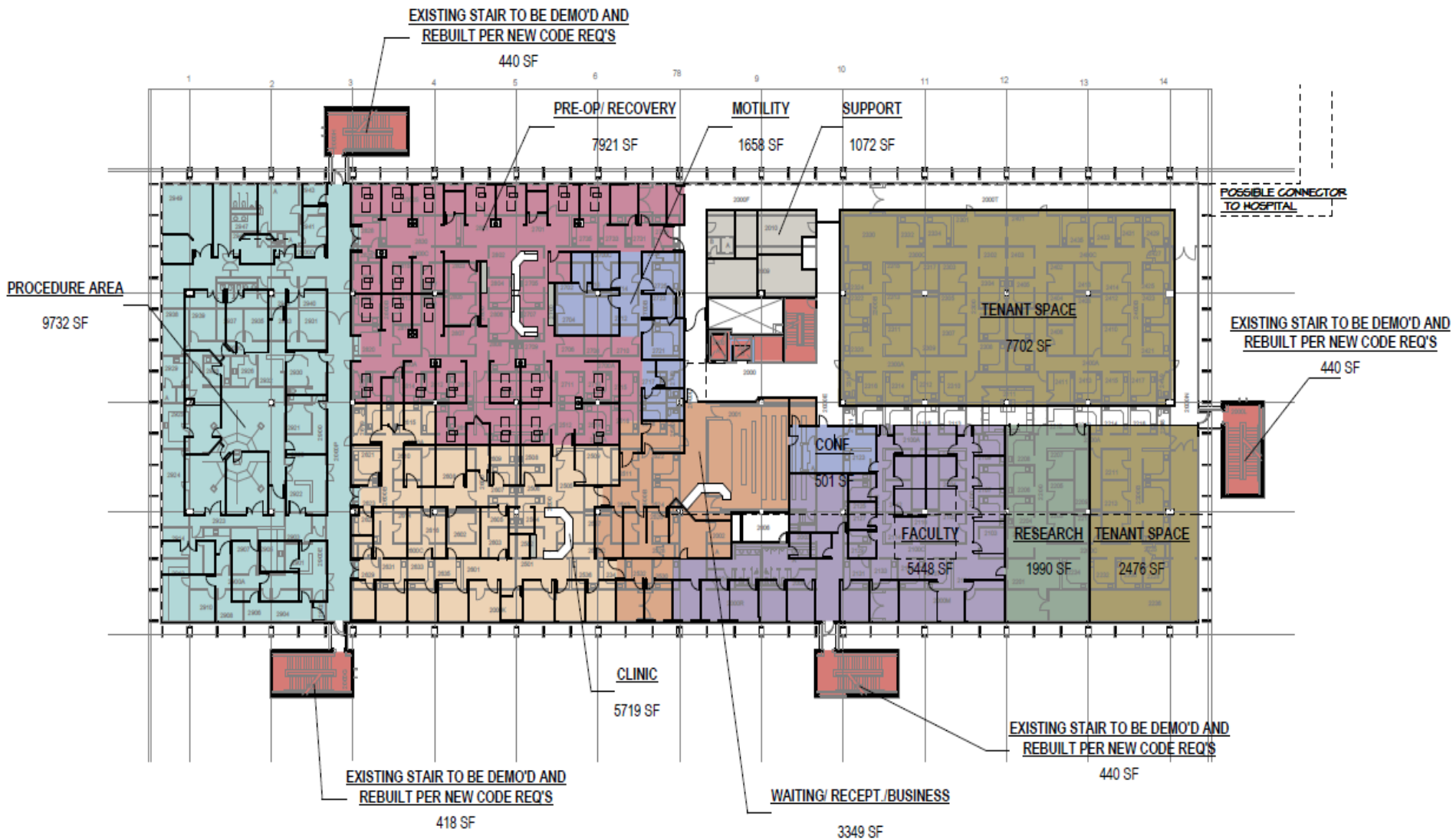

1 2nd Floor

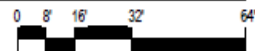

Digestive Health Service Line

Satish Rao, M.D.
Director

Medical Associate
Director

Administrative Director

Academic

Clinic Operations

Business Manager
1.0 FTE

Practice Site Coordinator, RN
1.0 FTE

Gastro

Research

MIDDS

Endoscopy

Support
Services

Clinic

Motility

Weight Loss
Program

Faculty
6.0 FTE

Assistant Professor
1.0 FTE

Faculty
3.0 FTE

Endoscopy Manager
1.0 FTE

Desk Operations
3.0 FTE

RN
1.0 FTE

Staff Nurse
2.0 FTE

Bariatric Coordinator
1.0 FTE

Faculty (TBD)
4.0 FTE

Nurse Clinician
1.0 FTE

Brian Lane M.D.
1.0 FTE

Senior Staff Nurse
9.0 FTE
Staff Nurse
2.0 FTE

Scheduling
3.0 FTE

LPN
3.0 FTE

LPN
1.0 FTE

Nutritionist
1.0 FTE

Support Staff
3.0 FTE

Research Assistant
1.0 FTE

Sean Lee, M.D.
1.0 FTE

SR.LPN/ LPN II
5.0 FTE

Billing Coordinator
2.0 FTE

Patient Care Asst.
3.0 FTE

Patient Care Tech
1.0 FTE

Physician Assistant
1.0 FTE

Michael Edwards
(REPLACEMENT)
1.0 FTE
Colorectal Surgeon

Gastroenterology
Technician
8.0 FTE

Faculty (TBD)
2.0 FTE

OR Assistant
2.0 FTE

NP/PA
3.0 FTE

Data Coordinator
.5 FTE

= Additional staff
required

Office Specialist
1.0 FTE

Unit Clerk
2.0 FTE

Nutritionist
1.0 FTE

Purchasing Clerk
1.0 FTE

Executive Wellness



Laura L. Mulloy, DO

Medical Director, Executive Wellness

Anthony L. Mulloy, PhD, DO

Associate Director, Executive Wellness

An experience like no other doctor's visit!

Our specialists are dedicated to individual care alone, with prompt, personalized evaluations, thorough assessments and education, and a high level of interest to ensure the patient's understanding of their own health.

Health Services

- A team-based review of your medical history, head-to-to physical examination and **fitness** evaluation. Our team an internist, oral surgeon, audiologist, ophthalmologist, dermatologist and an exercise physiologist
- Comprehensive laboratory testing, EKG, CT assisted Cardiac Calcium Scoring, Bone Density Scan
- Comprehensive vision and hearing exams
- Gender specific exams



Medicine Practice Site Leadership Team



Alyce Oliver, MD

Namita Mohanty, MD

Rosette Wyche, RN

Medicine Practice Site Staff



Dermatology Practice Site Leadership Team



Teresa Stovall, RN

Loretta Davis, MD

Dermatology Practice Site



First Row: Calandra White and Wanda Pryor

Second Row: Monica Jones, Cherie Green, Dana Atkins and Randall Wallace

Third Row: Teresa Stovall and Andrea Doyle

Renal Transplant Program



Carlos F. Zayas, M.D.
Professor
Medical Director
Transplant Nephrology
Director Transplant Fellowship Program

2 transplant surgeons Dr. Todd Merchen Leader
2+ transplant nephrologists
Living and deceased donor renal transplants
Kidney-pancreas transplant program (top 50 US)

Quality Improvement – Renal Transplant

	FY11	FY12	FY13	FY14	Mar-Jun
	Average			Target:	30 Days
Days from Referral to OC	84.8	69.7	49.5	42.8	38.7
Days from OC to Eval	69.4	48.2	39.2	17.7	11.3
Days from Referral to Eval	154.2	117.9	88.5	60.4	50.1
	Median				
Days from Referral to OC	74.0	63.9	41.1	33.0	33.1
Days from OC to Eval	66.9	35.9	34.8	11.6	11.7
Days from Referral to Eval	145.3	104.9	78.2	48.6	45.1
Kidney-LOS Median	7.4	6.9	6.4	5.5	5.5
Kidney-LOS Average	8.6	11.6	7.9	6.6	5.7
Kidney-UHC Benchmark Mean			5.8	5.7	
K/P-LOS Median	7.4	6.9	6.4	7.0	6.6
K/P-LOS Average	8.6	11.6	7.9	9.9	6.6
K/P-UHC Benchmark Mean			11.0	11.3	

Tracking Grid: Supply & Demand

Renal Transplant

	New referrals to program						4 month
	FY11	FY12	FY13	FY14 YTD	FY14 Target	Mar-Jun	Target
Total	830	1079	1055	1388	1450	501	483
Albany	8	11	3	34	4	14	1
Atlanta	7	10	7	15	10	9	3
Athens	33	43	46	50	63	17	21
Augusta	256	345	357	352	491	109	164
Macon	62	72	60	83	82	35	27
Savannah	123	137	115	187	158	74	53
Other Georgia	32	28	35	79	48	26	16
Columbia	167	202	234	228	322	75	107
Charleston	21	80	38	70	52	27	17
Florence	12	31	21	42	29	31	10
Greenville	103	116	135	193	186	66	62
Other SC & OOS	6	4	4	39	5	18	2
	up 25%	up 29%	down 1.6%	up 31%			

ELECTRONIC MEDICAL RECORDS UPDATES/UPGRADES



David Fallaw, MD
Physician IT Champion



2014 EMR UPGRADES

January 2014

- Emergency Dept. PPID/Bar Code Med Administration
- Radiology PACS Implementation. Start of image migration

February 2014

- Case Management/Social Work Electronic Documentation Released
- CHOG PPID (Positive Patient ID)/Bar Code Meds Admin

March 2014

- Cardiology PACS Go Live (Echo & Cath)

April 2014

- GR Health VIP Patient Portal Go Live
- MU Core 04/30 (PPID/BCMA) - GRMC

May 2014

- Vascular Access Bundled Powerplans

June 2014

- Elimination of Past Medical History Component of Powerchart

July 2014

- All problems entered prior to 06/23/2013 canceled

Electronic Medical Record Scheduled Projects

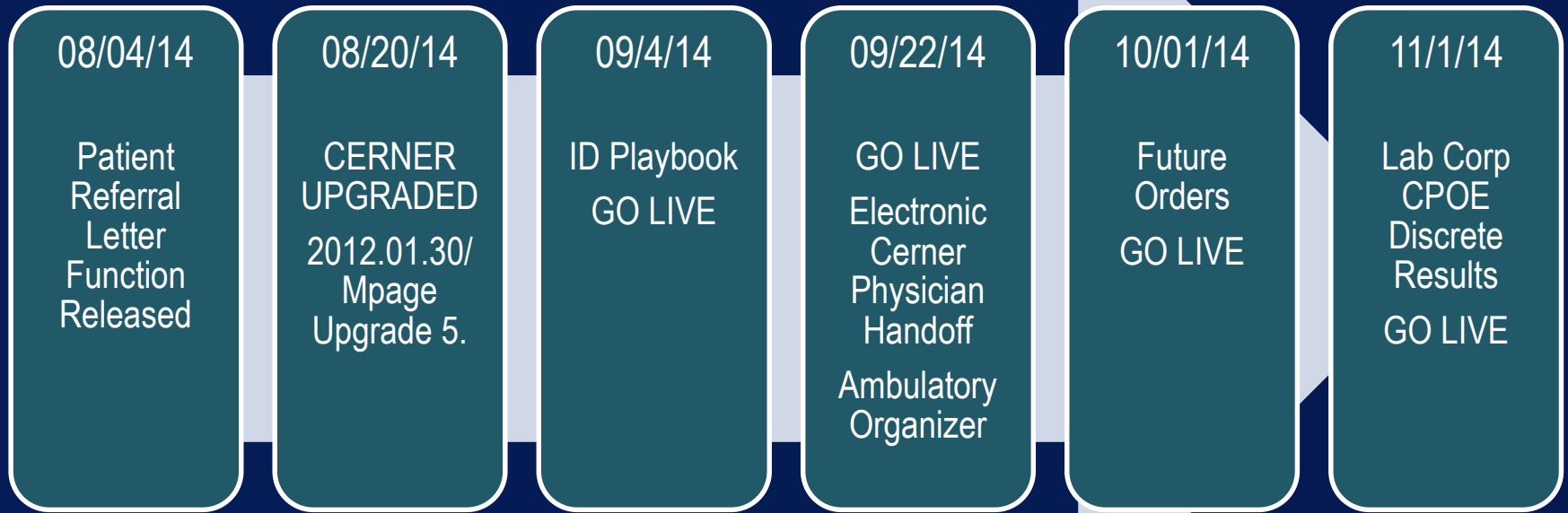

CONTINUED POWERNOTE
OPTIMIZATION

Quality Department Council

Michael Madaio	Sandra Clay	Tom Fortson	Namita Mohanty	Peter Rissing
Susan Andrews	Keven Dellsperger	Delandous Haynes	Carla Noe	Anthony Roberson
Amy Blanchard	Christina Deremer	Linda Henderson	Alyce Oliver	Pascha Schafer
Andrew Chao	Matthew Diamond	Clark McDonough	Teri Perry	Gyanendra Sharma
Kim Cheely	David Fallaw	Lee Merchen	Cynthia Pruett	Robert Sorrentino
Teresa Stovall	Judy Tyler	Steven Whitney	Michael Myers	

#	Description	Target Goal
1.	Improve CMS Core Measure Performance	Top 45%ile
2.	Decrease HAI (CLABSI, CAUTI)	CLABSI (2.5/m); CAUTI (7/m)
3.	Improve Documentation	Exp Mortality 2.62%
4.	Improve RAMI	Median UHC
5.	Safety: Use of VTE prophylaxis	89%
6.	Alert/alarm fatigue	Measure being developed
9.	Improve throughput – decrease LOS	LOS/CMI <3.13
10.	Patient satisfaction (HCAHPS)	Physician Communication 50%ile or better

GOALS: Clinical

- Transition from a top down to a team based care system through engagement of all members of the health care team.
- Provide quality and value in all clinical services.
- Address the health care needs and diversity of our communities.
- Enhance access to complex care.
- Use the service line and multi-disciplinary team based approach as a means to deliver high quality, cost efficient, compassionate care

Strategic Priority #4

People & Process Excellence

Maximize our leadership capacity at all levels through professional growth.

Mentoring Committee Members

Jennifer Giancola, PhD	Associate Professor, St Louis University
Laura Mulloy, DO	Section Chief, Professor, Nephrology
Andy Albritton, MD	Associate Dean, Curriculum
David Fallaw, MD	Assistant Professor, General Internal Medicine
Edward Chin, MD	Professor, Endocrinology
Jason White, MD	Associate Professor, Nephrology
Joyce Gonzales, MD	Assistant Professor, Pulmonary
Lee Merchen, MD	Assistant Professor, General Internal Medicine
Paul Wallach, MD	Vice Dean, Academic Affairs
Rhonda Colombo, MD	Assistant Professor, Infectious Disease
Stephanie Baer, MD	Assistant Professor, Infectious Disease
Vincent Robinson, MBBS	Professor, Cardiology
William Salazar, MD	Professor, General Internal Medicine

Be a Mentor:

- You have knowledge
- You have experience
- You have wisdom
- You have insight
- You care about GRU



FOR MORE INFORMATION ON
BECOMING A MENTOR
PLEASE CONTACT
AUDREY FORBES

What is Mentoring?

- A process in which a mentor helps a protégé develop knowledge, skills, and abilities
- A partnership which allows both parties to realize their full potential

Be a Protégé

- You have a desire to learn
- You want to develop your physician skills
- You want to learn leadership principles
- You want to contribute to GRU's future



IF YOU WOULD LIKE TO BECOME
A NEW/JUNIOR OR MID-CAREER
PROTÉGÉ PLEASE CONTACT
AUDREY FORBES

GRU Department of Medicine Mentoring Program 2014

Benefits of Mentoring

- Individual growth
- Career development
- Leadership/Managerial skills
- Professional Growth
- Satisfaction of helping others
- Refining leadership skills
- Knowledge transfer
- Recruitment and retention
- Future leaders recognized

How Does it work?

- Mentor and Protégé are matched by the Mentoring Committee
- The Mentor and Protégé meet periodically, creating a positive learning experience
- Information, training, and support are provided to make this Mentoring Program effective and rewarding for you!

Leadership: Medical Admissions Committee of MCG Georgia Faculty Senate

• David Fallaw, MD	• Walter Moore, MD
• John Thornton, MD	• Charles Green, MD
• Richard Cameron, MD	• Howard Cohen, MD
• Paul Dainer, MD	• Robert Sorrentino, MD

Department of Medicine

Section Chiefs



Neil Weintraub, MD
Interim Chief, Cardiology



Loretta Davis, MD
Section Chief, Derm



Anthony Mulloy, DO
Section Chief, Endo



Satish Rao, MD
Section Chief, Gastro



Walter Moore, MD
Interim Chief, GIM



Abdullah Kutlar, MD
Interim Chief, HemOnc



Jose Vazquez, MD
Section Chief, ID



Laura Mulloy, DO
Section Chief, Neph



Bruce Davis, MD
Section Chief, Pulm



Laura Carbone, MD
Section Chief, Rheum

DOM Section Managers



Michelle Hays Teresa Stovall Elizabeth Jones Lynnette Ellison Sherry Brown Larry Howell Donna Renew Charles Stewart
Gastro/Pulm Clinic Manger Hem/Onc Endo Cardiology Ryan White/I.D GIM/Rheum Neph/Derm

Promotion and Tenure 2014



Gerald Crites, MD/Med
UGA/Athens Partnership
Associate Professor



Asha Nayak, MBBS
Hem/Onc and Cancer Center
Associate Professor



Scott Richardson, MD
UGA/Athens Partnership
Professor, Tenure



Gang Zhou, PhD
Hem/Onc
Associate Professor, Tenure



Ahmed Chadli, PhD
Cancer Research Center
Associate Professor

Staff Promotions

Staff Name	Section	Promoted To:
Jennifer Adams	Cardiology	Administrative Assistant
Geri Floyd	CCOP	Research Manager
Ashley Dutton	Chairman Office	Business Operations Specialist
Dottie Zielinski	Dermatology	Office Specialist
Helen Smith	Gastroenterology	Administrative Assistant
Elizabeth Jones	Hematology/Oncology	Department Administrator 2
Michelle Torres	IM Residency Program	Residency Program Coordinator
Brandi McCorkle	Nephrology	Administrative Assistant
Shawnda Claxton	Rheumatology	Administrative Assistant



Goals: People and Process Excellence

- Create a culture of integrity, transparency, respect, collaboration and openness.
- Ensure operational excellence to advance all MCG mission areas through appropriate infrastructure, systems, processes, and funding.
- Promote career development through mentoring and education for faculty, staff, students, and residents at all levels of their careers.
- Recruit, retain, recognize, and reward exemplary and loyal faculty, staff, residents and students.

Strategic Priority #5

Cultural Transformation and Diversity

Create a diverse, inclusive environment that supports the needs and opportunities of faculty, students, residents, and staff.

Hem/Onc Sickle Cell Program

- Funding: \$8 M (Direct Costs)
- October 2013: Sickle Cell Center relocated to Shepard Building
- Care for 630 Adult patients
- Satellite clinics
 - Albany, Macon, Savannah (monthly)
 - Valdosta and Waycross/Blackshear (bi-monthly)
- Research
 - Fetal hemoglobin induction
 - Plasma exchange in acute chest/multi-organ failure
 - Bone marrow transplantation, modifiers of disease severity
 - Chronic and acute painful episodes
 - Psychosocial aspects
 - Medical home model,
 - ED/Observation unit pathway for treatment of painful episodes



Abdullah Kutlar, MD

Fulbright – Fogarty Award



Brett Heimlich, a student at MCG at Georgia Regents University, received a prestigious Fulbright-Fogarty Award and will spend the next year in Malawi studying sickle cell disease

Ryan White Community Outreach Program

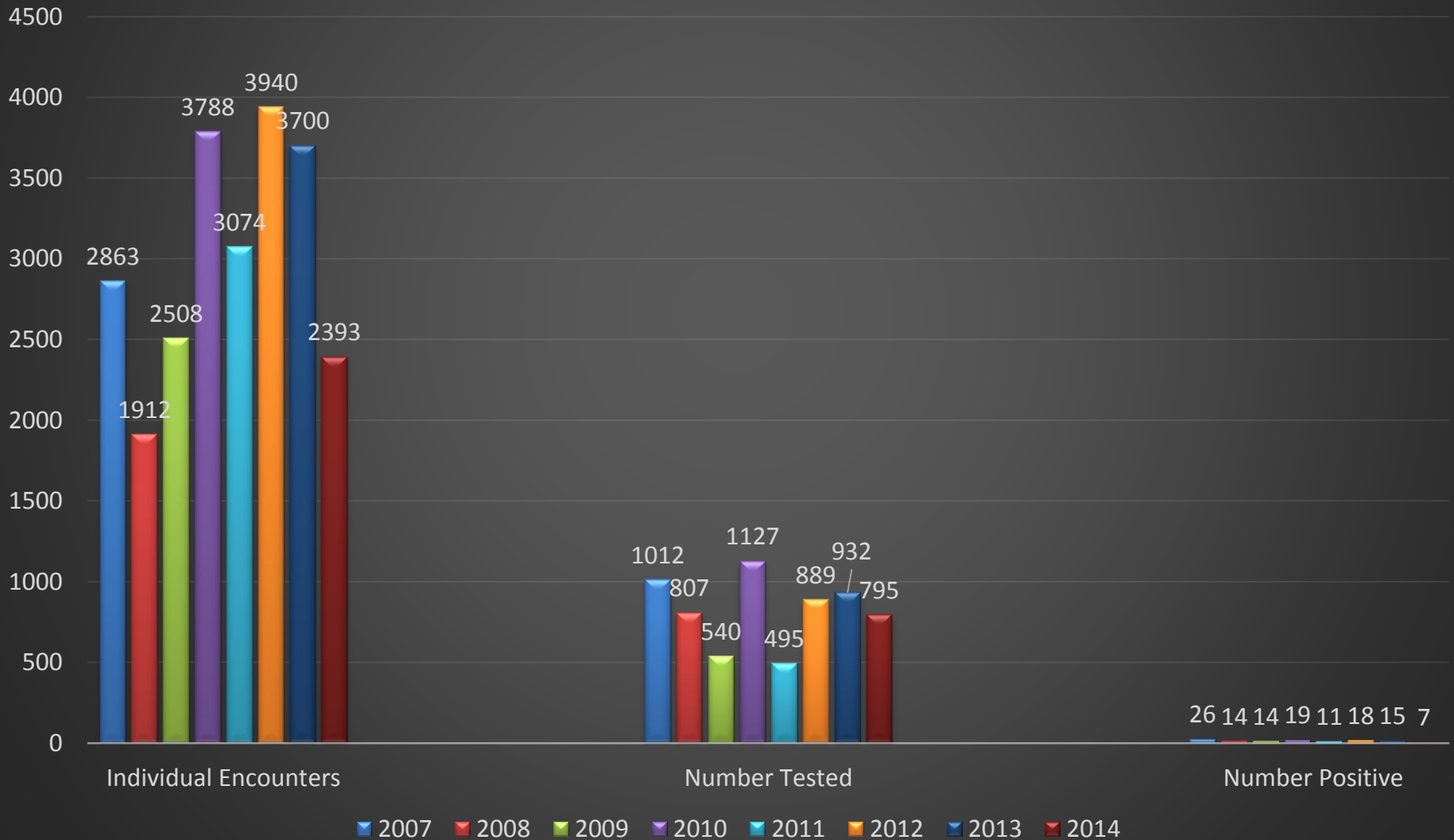

Clinica Latina & Equality Clinic

Drs. William Salazar and Dr. Bruce Leclair

- 2 Free Clinics each month
- Helps provide culturally-competent, interdisciplinary care to underinsured members of the Hispanic and LGBTQ communities



William Salazar, MD

Goals: Cultural Transformation and Diversity

- Develop and implement practices and policies of diversity and inclusivity that **facilitate a culturally sensitive college and academic health center environment.**
- Optimize diversity and cultural sensitivity **by fostering community engagement and partnerships focused on reducing factors associated with health care disparities.**
- **Recruit, matriculate, and graduate an excellent, talented, and diverse student body to meet the needs of the communities we serve.**
- Grow academic enrichment pipeline programs in partnership with the University System of Georgia and other K-16 schools to **promote health science interest and facilitate admissions and matriculation of students from under-represented populations.**

Strategic Priority #6

External Affairs

Engage our alumni and community by advancing MCG growth through philanthropy and communications.

Medicine Grand Rounds Faculty Speakers

Sept 2013 – June 2014

Speaker	Section	Speaker	Section
Robert Sorrentino, MD	Cardiology	Shou-Ching Tang, MD	Hem/Onc
William Maddox, MD	Cardiology	Claude Sportes, MD	Hem/Onc
Neil Weintraub, MD	Cardiology	Frank Mott, MD	Hem/Onc
Ralph Gillies, MD	Ell's Education	Research Residents	Housestaff
Sumanth Daram, MD	Gastro	Jose Vazquez, MD	Infectious Disease
John Affronti, MD	Gastro	Lu Huber, MD	Nephrology
Humberto Sifuentes, MD	Gastro	David Gaitonde, MD	Nephrology
Jaspal Gujral, MD	GIM	David Hess, MD	Neurology
David Fallaw, MD	GIM	Laura Carbone, MD	Rheumatology
Stephen Black, MD	GIM	Brian Lane, MD	Surgery

Medicine Grand Rounds

Visiting Professors 2013-2014



Charles Argoff, MD
Albany Medical Center



Jack Sobel, MD
Wayne State University



Balakuntalam Kasinath, MD
University of Texas



Jessica Fairley, MD
Emory University



Frank Mitros, MD
University of Iowa



Karen Johnson, MD
University of TN



Josef Prchal, MD
University of Utah



Debendra Pattanaik, MD
University of Tenn



James Tumlin, MD
University of TN
Chattanooga



Guillermo Umpierrez, MD
Emory University



Arthur Beyder, MD
Mayo Clinic, MN

Sydenstricker Endowment Leader



Joseph Bailey, MD

Medicine Grand Rounds Sydenstricker 2013-2014



Arthur Feldman, MD
Executive Dean,
Chief Academic Officer,
Professor, Medicine
Professor, Physiology
Temple University, PA
November 2013



Lee Goldman, MD
Dean of the Faculties of Health
Sciences and Medicine
Executive Vice President for Health
and Biomedical Sciences
Columbia University, NY
April 2014

Upcoming Sydenstricker Speaker March 2015



Talmadge King, Jr., MD
Professor and Chair, Department of Medicine
University of California San Francisco

“America’s Top Doctors” 2014

Fourteen physicians from GRU were included in the 13th edition of this national patient reference guide, Georgia Regents Medical Center is the only hospital in the Augusta-Aiken area with physicians included in this prestigious list. This included four members from the DOM.



Satish S. Rao, MD
Gastroenterology



Robert A. Sorrentino, MD
Cardiology



Walter J. Moore, MD
Rheumatology



Sheldon E. Litwin, MD
Cardiology

Abdullah Kutlar, MD

July 2014

Dr. William N. and Josephine R.
Agostas Endowed Chair for Internal
Medicine



Master of American College of Physicians

Mastership recognizes a practitioner of internal medicine who demonstrates strength of character and compassion and serves as an mentor and advocate. Dr. Moore was recognized during the college's annual meeting in April in Orlando.

Walter J. Moore, MD
Professor of Medicine
Rheumatology
April, 2014



2014 Outstanding Faculty Award

In nominating Albritton for the award, a colleague noted that few individuals have served MCG as extensively and that his most important impact has been his service to and support of medical students and residents.

T. Andrew Albritton, MD
Senior Associate Dean for Curriculum



William Salazar, MD

- Appointed to the newly formed National Board of Medical Examiners Communications Task Force (12 members).
- Goal: To develop methods for assessing future physicians' communication and interpersonal skills and professionalism for the USMLE and the NBME.



A Pharmacogenetic versus a Clinical Algorithm for Warfarin Dosing

Stephen E. Kimmel, M.D., Benjamin French, Ph.D., Scott E. Kasner, M.D., Julie A. Johnson, Pharm.D., Jeffrey L. Anderson, M.D., Brian F. Gage, M.D., Yves D. Rosenberg, M.D., Charles S. Eby, M.D., Rosemary A. Madigan, R.N., M.P.H., Robert B. McBane, M.D., Sherif Z. Abdel-Rahman, Ph.D., Scott M. Stevens, M.D., Steven Yale, M.D., Emile R. Mohler III, M.D., Margaret C. Fang, M.D., Vinay Shah, M.D., Richard B. Horenstein, M.D., Nita A. Limdi, Pharm.D., Ph.D., James A.S. Muldowney III, M.D., Jaspal Gujral, M.B., B.S., Patrice Delafontaine, M.D., Robert J. Desnick, M.D., Ph.D., Thomas L. Ortel, M.D., Ph.D., Henry H. Buijett, M.D., Robert C. Pendleton, M.D., Nancy L. Geller, Ph.D., Jonathan L. Halperin, M.D., Samuel Z. Goldhaber, M.D., Michael D. Caldwell, M.D., Ph.D., Robert M. Califf, M.D., and Jonas H. Ellenberg, Ph.D., for the COAG Investigators*

ABSTRACT

BACKGROUND

The clinical utility of genotype-guided (pharmacogenetically based) dosing of warfarin has been tested only in small clinical trials or observational studies, with equivocal results.

METHODS

We randomly assigned 1015 patients to receive doses of warfarin during the first 5 days of therapy that were determined according to a dosing algorithm that included both clinical variables and genotype data or to one that included clinical variables only. All patients and clinicians were unaware of the dose of warfarin during the first 4 weeks of therapy. The primary outcome was the percentage of time that the international normalized ratio (INR) was in the therapeutic range from day 4 or 5 through day 28 of therapy.

RESULTS

At 4 weeks, the mean percentage of time in the therapeutic range was 45.2% in the genotype-guided group and 45.4% in the clinically guided group (adjusted mean difference, [genotype-guided group minus clinically guided group], -0.2 ; 95% confidence interval, -3.4 to 3.1 ; $P=0.91$). There also was no significant between-group difference among patients with a predicted dose difference between the two algorithms of 1 mg per day or more. There was, however, a significant interaction between dosing strategy and race ($P=0.003$). Among black patients, the mean percentage of time in the therapeutic range was less in the genotype-guided group than in the clinically guided group. The rates of the combined outcome of any INR of 4 or more, major bleeding, or thromboembolism did not differ significantly according to dosing strategy.

CONCLUSIONS

Genotype-guided dosing of warfarin did not improve anticoagulation control during the first 4 weeks of therapy. (Funded by the National Heart, Lung, and Blood Institute and others; COAG ClinicalTrials.gov number, NCT00839657.)

The authors' affiliations are listed in the Appendix. Address reprint requests to Dr. Kimmel at the Center for Therapeutic Effectiveness Research, 923 Blockley Hall, 423 Guardian Dr., Philadelphia, PA 19104-6021, or at stovrek@mail.med.upenn.edu.

*A complete list of investigators and committees in the Clarification of Optimal Anticoagulation through Genetics (COAG) trial is provided in the Supplementary Appendix, available at NEJM.org.

This article was published on November 19, 2013, at NEJM.org.

N Engl J Med 2013;369:2283-93.
DOI: 10.1056/NEJMoa1310669
Copyright © 2013 Massachusetts Medical Society



Jaspal Gujral, MD
Internal Medicine

kidney

INTERNATIONAL

“A human monoclonal antibody against the collagen type IV $\alpha 3\text{NC1}$ domain is a non-invasive optical biomarker for glomerular diseases”

Kapil Chaudhary, Daniel T Kleven,
Tracy L McGaha, Michael P Madaio

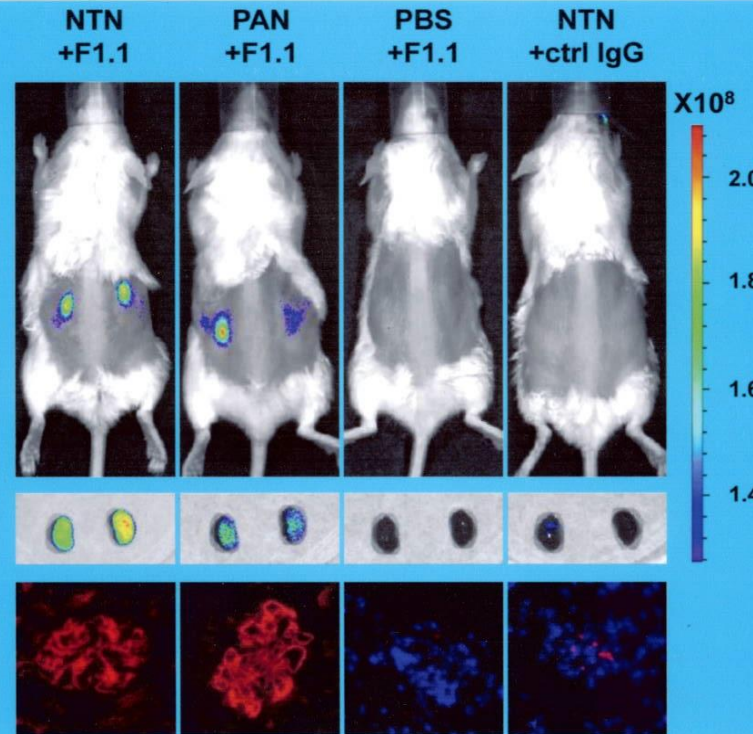

VOLUME 84 | ISSUE 2 | AUGUST 2013

<http://kidney-international.com>

Lack of suPAR specificity in proteinuric kidney disease

Coronary plaque neovascularization in CKD

Stem cells reduce peritoneal fibrosis

NOD2 promotes diabetic kidney injury

DOM Webpages/Updates

Georgia Regents University x Department of Medicine x +

www.gru.edu/mcg/medicine/

Most Visited Getting Started GHSU Login Suggested Sites Web Slice Gallery

WELCOME TO THE

DEPARTMENT OF MEDICINE

AT THE MEDICAL COLLEGE OF GEORGIA

Home About Us Education & Training Patient Care Research Giving Contact Us

f Twitter DOM SECTIONS Go

Home » Colleges » Medical College of Georgia » Department of Medicine » Welcome



Education & Training

Our faculty is devoted to the education and development of outstanding clinicians according to core competencies of patient care, medical knowledge, practice-based learning, communication, professionalism, and systems-based practice.



Patient Care and Clinical Service

GRU is working to identify under-served disease populations, and link clinical service lines with existing areas of research to address local and regional health disparities.



Research

Our state-of-the-art research facilities, collaborative research environment, and outstanding clinical resources place GRU at the leading edge of new scientific advancements.

Website Updates for Better Communication

- Section Chief's Bios
- Links to PubMed/SciVal/GRUHealth
- Google Calendar
- TRP Website
- Accolades/Announcements
- User friendly navigation
- Search friendly

Goals:

- DOM Faculty bios
- Videos to highlight section chiefs and their sections
- Live streaming for Grand Rounds for faculty at VA and Trinity

The screenshot shows a web browser window displaying a faculty profile for Michael P. Madaio, MD. The page includes a header with a 'Back to Faculty List' link, a portrait photo of Dr. Madaio, and his title: 'Michael P. Madaio, MD, Sydenstricker Professor and Chairman, Department of Medicine, Medical College of Georgia at Georgia Regents University'. A detailed biography follows, describing his appointment in 2008, his education at Fairfield and Albany Medical Colleges, his residency at Tufts, and his extensive research and clinical experience in nephrology and immunology. Below the biography are three sections: 'Madaio Research Profile (SciVal)', 'Madaio Publications (Pub Med)', and 'Madaio Physician Profile (GRHealth)'. To the right of the biography is a photo of Brett Heimlich with a child, accompanied by text stating he has received a Fulbright-Fogarty Award to study Sickle Cell Disease in Malawi. Below this is an 'UPCOMING EVENTS' section listing three events: 'DOM Grand Rounds Dr Haberchak' on Tuesday, Sep. 2nd at 12:00 PM; 'GRU Idol Auditions' on Tuesday, Sep. 2nd at 5:30 PM; and 'Word 2010: Level 1' on Wednesday, Sep. 3rd at 9:00 AM. The browser's address bar shows 'pp' and navigation icons are visible in the top right corner.

CME Credit



[Home](#) [About Us](#) [Education & Training](#) [Patient Care](#) [Research](#) [Giving](#) [Contact Us](#)

[f](#) [t](#)

- [DOM Home](#)
- [DOM Activities 2012-13](#)
- [DOM State of the Dept 2013](#)
- [Faculty & Staff Resources](#)
- [Institutes and Centers](#)
- [Off-Campus Facilities](#)
- [Sections Calendar](#)
- [Translational Research Program \(TRP\)](#)
- [Contact Us](#)

CONTACT US

Department of Medicine
Georgia Regents University
1120 Fifteenth Street, Bl 5076
Augusta, GA 30912

T 706-721-2941 | F 706-721-9405
A Audrey Forbes

[Home](#) > [Colleges](#) > [Medical College of Georgia](#) > [Department of Medicine](#) > [Grand Rounds](#)

Upcoming Grand Rounds

Date: Tuesday September 2, 2014
Time: Noon
Location: Lee Auditorium
Speaker: Dr David Haburchak
Title: "Ebola, Fear, and Courage"

Date: Tuesday September 9, 2014
Time: Noon
Location: Lee Auditorium
Speaker: Dr Michael Madaio
Title: State of the DOM

Date: Tuesday September 16, 2014
Time: Noon
Location: Lee Auditorium
Speaker: Dr David Swanson
Title: Designing Assessment Systems to Promote Student Learning:
Using the Assessment Tail to Wag the Curriculum Dog

[View Grand Rounds Presentation for CME Credit](#)

Who's In The News - DOM



Satish Rao, MD (GI) in Elle Magazine
"Should You Be Taking a Probiotics" 7/2014



Jose Vazquez, MD (ID) on "Antibiotic Resistance" in the Augusta Chronicle 3/4/14



Robert Sorrentino, MD (Cardiology)
Implanted New Life Saving Heart Device in the Augusta Chronicle 3/7/14



Lu Huber, MD (Nephrology)
"Obese, Older, Caucasian Women on Dialysis Most at Risk for Rare, Deadly Condition"



Adam Berman, MD (Cardiology) on "Stem Cell Study"
WJBF with Jenny Montgomery 3/12/14

New Faculty

June 2013 – August 2014



Frank Mott, MD
Hematology/Oncology



Humberto Sifuentes, MD
Gastroenterology



Rajan Kapoor, MBBS
Nephrology



Candice Lovelace, MD
Internal Medicine





Vernon Spaulding, MD
Gastroenterology
March 5, 2014



Charles Lutcher, MD
Hematology/Oncology
Retired: July 1, 2014



Malliga Ganapathy, MD
Infectious Disease
Retired: July 31, 2014

Thank you for your dedication and
service to the School of Medicine

Special Thanks



Justin Pantano
Department
Administrator



Ashley Dutton
Business Operations
Specialist



Audrey Forbes
Administrative
Assistant



Velinda Thomas
Accountant